

**ISSUED FOR CONSTRUCTION**  
11 September 2018

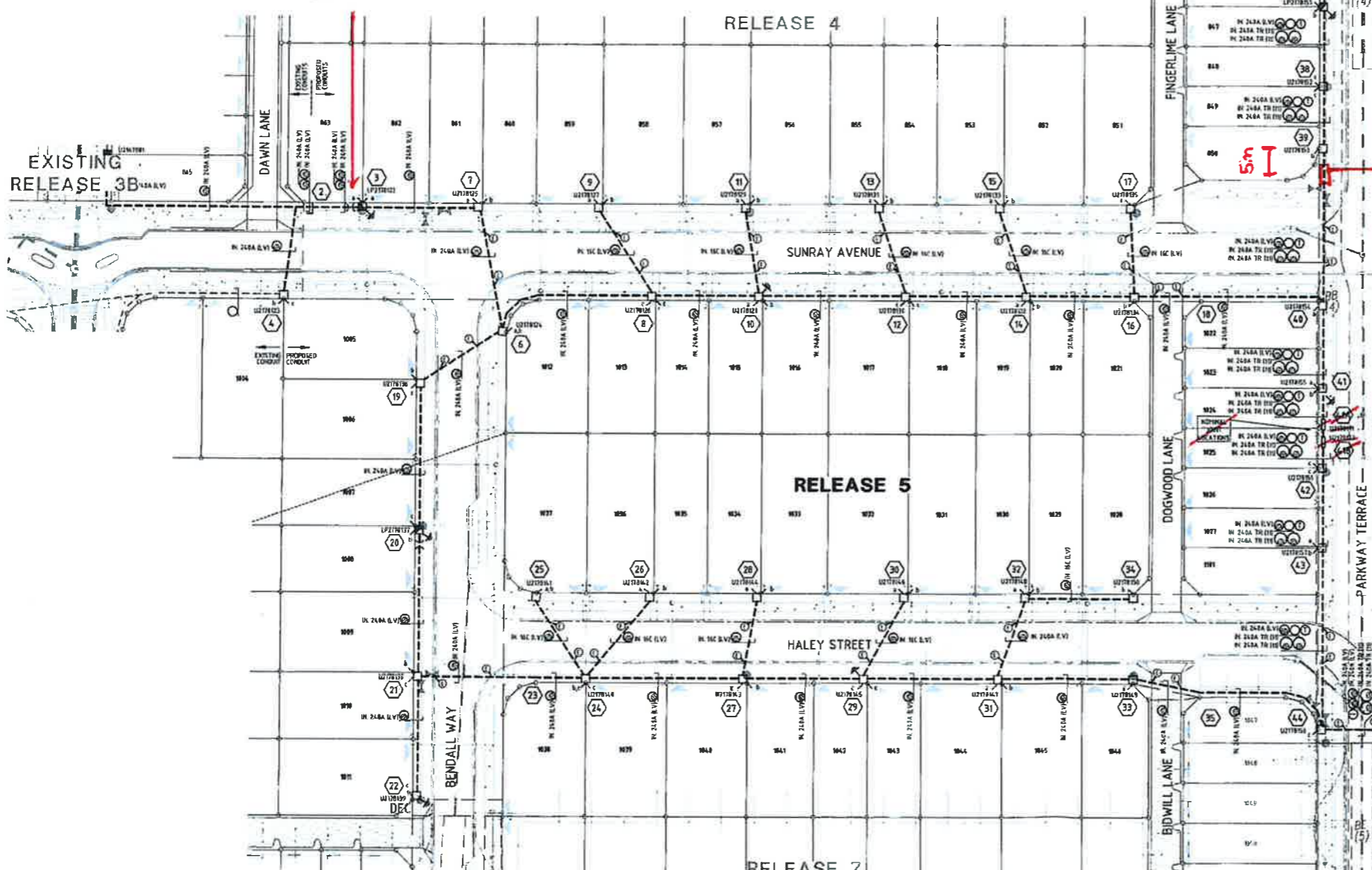
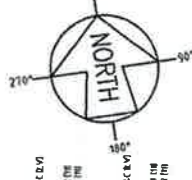
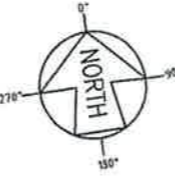

EXTRA PILLAR FOR SPORTS PARK  
42209373  
JOINS 'A-A'

MV JOINT LOCATIONS  
41A + 41B

MV JOINT LOCATION  
RE-LOCATED DUE TO BLOCK WALLS  
FOOTPATHS

ST 48.  
EXTRA PILLAR FOR SPORTS PARK  
42209373

OWNER'S SERVICES  
PHONE: (07) 3622 4333 FAX: (07) 3622 4334  
NAME: A. Neville  
SIGN: [Signature]  
DATE: 21-9-2018

<table border="1"> <tr><th>REV</th><th>DATE</th><th>DETAILS</th><th>DRAWN</th><th>CHECKED</th><th>APPROVED</th><th>DATE</th><th>REFERENCE DRAWING TITLE</th></tr> <tr><td> </td><td> </td><td> </td><td> </td><td> </td><td> </td><td> </td><td> </td></tr> </table>	REV	DATE	DETAILS	DRAWN	CHECKED	APPROVED	DATE	REFERENCE DRAWING TITLE									<table border="1"> <tr><th>ALIGNMENTS</th><th>ENERGEX CH</th><th>ENERGEX UC</th><th>TELSTRA</th><th>GAS</th><th>NP GAS</th><th>WATER</th><th>SEWERAGE</th><th>SEWER</th></tr> <tr><td> </td><td> </td><td> </td><td> </td><td> </td><td> </td><td> </td><td> </td><td> </td></tr> </table>	ALIGNMENTS	ENERGEX CH	ENERGEX UC	TELSTRA	GAS	NP GAS	WATER	SEWERAGE	SEWER										<table border="1"> <tr><th>SCRC</th><th>REF: REC/M/0063 &amp; 0PM/M/0391</th><th>ELECTRICAL CONTRACTOR</th><th>CV SERVICES</th></tr> <tr><td> </td><td> </td><td> </td><td> </td></tr> </table>	SCRC	REF: REC/M/0063 & 0PM/M/0391	ELECTRICAL CONTRACTOR	CV SERVICES					<table border="1"> <tr><th>ELECTRO</th><th>Technical Consultants</th></tr> <tr><td> </td><td> </td></tr> </table>	ELECTRO	Technical Consultants			<table border="1"> <tr><th>CERTIFICATION</th><th>NAME</th><th>DATE</th><th>RPEQ No</th><th>APPROVED</th><th>DATE</th></tr> <tr><td> </td><td> </td><td> </td><td> </td><td> </td><td> </td></tr> </table>	CERTIFICATION	NAME	DATE	RPEQ No	APPROVED	DATE							<table border="1"> <tr><th>63 LOT SUBDIVISION</th><th>ELECTRICAL RETICULATION</th><th>RELEASE 5</th></tr> <tr><td> </td><td> </td><td> </td></tr> </table>	63 LOT SUBDIVISION	ELECTRICAL RETICULATION	RELEASE 5				<table border="1"> <tr><th>SCALE</th><th>AS SHOWN</th><th>A1</th></tr> <tr><td> </td><td> </td><td> </td></tr> </table>	SCALE	AS SHOWN	A1			
REV	DATE	DETAILS	DRAWN	CHECKED	APPROVED	DATE	REFERENCE DRAWING TITLE																																																																					
ALIGNMENTS	ENERGEX CH	ENERGEX UC	TELSTRA	GAS	NP GAS	WATER	SEWERAGE	SEWER																																																																				
SCRC	REF: REC/M/0063 & 0PM/M/0391	ELECTRICAL CONTRACTOR	CV SERVICES																																																																									
ELECTRO	Technical Consultants																																																																											
CERTIFICATION	NAME	DATE	RPEQ No	APPROVED	DATE																																																																							
63 LOT SUBDIVISION	ELECTRICAL RETICULATION	RELEASE 5																																																																										
SCALE	AS SHOWN	A1																																																																										
<table border="1"> <tr><th>REV</th><th>DATE</th><th>DETAILS</th><th>DRAWN</th><th>CHECKED</th><th>APPROVED</th><th>DATE</th><th>REFERENCE DRAWING TITLE</th></tr> <tr><td> </td><td> </td><td> </td><td> </td><td> </td><td> </td><td> </td><td> </td></tr> </table>	REV	DATE	DETAILS	DRAWN	CHECKED	APPROVED	DATE	REFERENCE DRAWING TITLE									<table border="1"> <tr><th>SCRC</th><th>REF: REC/M/0063 &amp; 0PM/M/0391</th><th>ELECTRICAL CONTRACTOR</th><th>CV SERVICES</th></tr> <tr><td> </td><td> </td><td> </td><td> </td></tr> </table>	SCRC	REF: REC/M/0063 & 0PM/M/0391	ELECTRICAL CONTRACTOR	CV SERVICES					<table border="1"> <tr><th>ELECTRO</th><th>Technical Consultants</th></tr> <tr><td> </td><td> </td></tr> </table>	ELECTRO	Technical Consultants			<table border="1"> <tr><th>CERTIFICATION</th><th>NAME</th><th>DATE</th><th>RPEQ No</th><th>APPROVED</th><th>DATE</th></tr> <tr><td> </td><td> </td><td> </td><td> </td><td> </td><td> </td></tr> </table>	CERTIFICATION	NAME	DATE	RPEQ No	APPROVED	DATE							<table border="1"> <tr><th>63 LOT SUBDIVISION</th><th>ELECTRICAL RETICULATION</th><th>RELEASE 5</th></tr> <tr><td> </td><td> </td><td> </td></tr> </table>	63 LOT SUBDIVISION	ELECTRICAL RETICULATION	RELEASE 5				<table border="1"> <tr><th>SCALE</th><th>AS SHOWN</th><th>A1</th></tr> <tr><td> </td><td> </td><td> </td></tr> </table>	SCALE	AS SHOWN	A1																						
REV	DATE	DETAILS	DRAWN	CHECKED	APPROVED	DATE	REFERENCE DRAWING TITLE																																																																					
SCRC	REF: REC/M/0063 & 0PM/M/0391	ELECTRICAL CONTRACTOR	CV SERVICES																																																																									
ELECTRO	Technical Consultants																																																																											
CERTIFICATION	NAME	DATE	RPEQ No	APPROVED	DATE																																																																							
63 LOT SUBDIVISION	ELECTRICAL RETICULATION	RELEASE 5																																																																										
SCALE	AS SHOWN	A1																																																																										
<table border="1"> <tr><th>REV</th><th>DATE</th><th>DETAILS</th><th>DRAWN</th><th>CHECKED</th><th>APPROVED</th><th>DATE</th><th>REFERENCE DRAWING TITLE</th></tr> <tr><td> </td><td> </td><td> </td><td> </td><td> </td><td> </td><td> </td><td> </td></tr> </table>	REV	DATE	DETAILS	DRAWN	CHECKED	APPROVED	DATE	REFERENCE DRAWING TITLE									<table border="1"> <tr><th>SCRC</th><th>REF: REC/M/0063 &amp; 0PM/M/0391</th><th>ELECTRICAL CONTRACTOR</th><th>CV SERVICES</th></tr> <tr><td> </td><td> </td><td> </td><td> </td></tr> </table>	SCRC	REF: REC/M/0063 & 0PM/M/0391	ELECTRICAL CONTRACTOR	CV SERVICES					<table border="1"> <tr><th>ELECTRO</th><th>Technical Consultants</th></tr> <tr><td> </td><td> </td></tr> </table>	ELECTRO	Technical Consultants			<table border="1"> <tr><th>CERTIFICATION</th><th>NAME</th><th>DATE</th><th>RPEQ No</th><th>APPROVED</th><th>DATE</th></tr> <tr><td> </td><td> </td><td> </td><td> </td><td> </td><td> </td></tr> </table>	CERTIFICATION	NAME	DATE	RPEQ No	APPROVED	DATE							<table border="1"> <tr><th>63 LOT SUBDIVISION</th><th>ELECTRICAL RETICULATION</th><th>RELEASE 5</th></tr> <tr><td> </td><td> </td><td> </td></tr> </table>	63 LOT SUBDIVISION	ELECTRICAL RETICULATION	RELEASE 5				<table border="1"> <tr><th>SCALE</th><th>AS SHOWN</th><th>A1</th></tr> <tr><td> </td><td> </td><td> </td></tr> </table>	SCALE	AS SHOWN	A1																						
REV	DATE	DETAILS	DRAWN	CHECKED	APPROVED	DATE	REFERENCE DRAWING TITLE																																																																					
SCRC	REF: REC/M/0063 & 0PM/M/0391	ELECTRICAL CONTRACTOR	CV SERVICES																																																																									
ELECTRO	Technical Consultants																																																																											
CERTIFICATION	NAME	DATE	RPEQ No	APPROVED	DATE																																																																							
63 LOT SUBDIVISION	ELECTRICAL RETICULATION	RELEASE 5																																																																										
SCALE	AS SHOWN	A1																																																																										

**ISSUED FOR CONSTRUCTION**  
11 September 2018

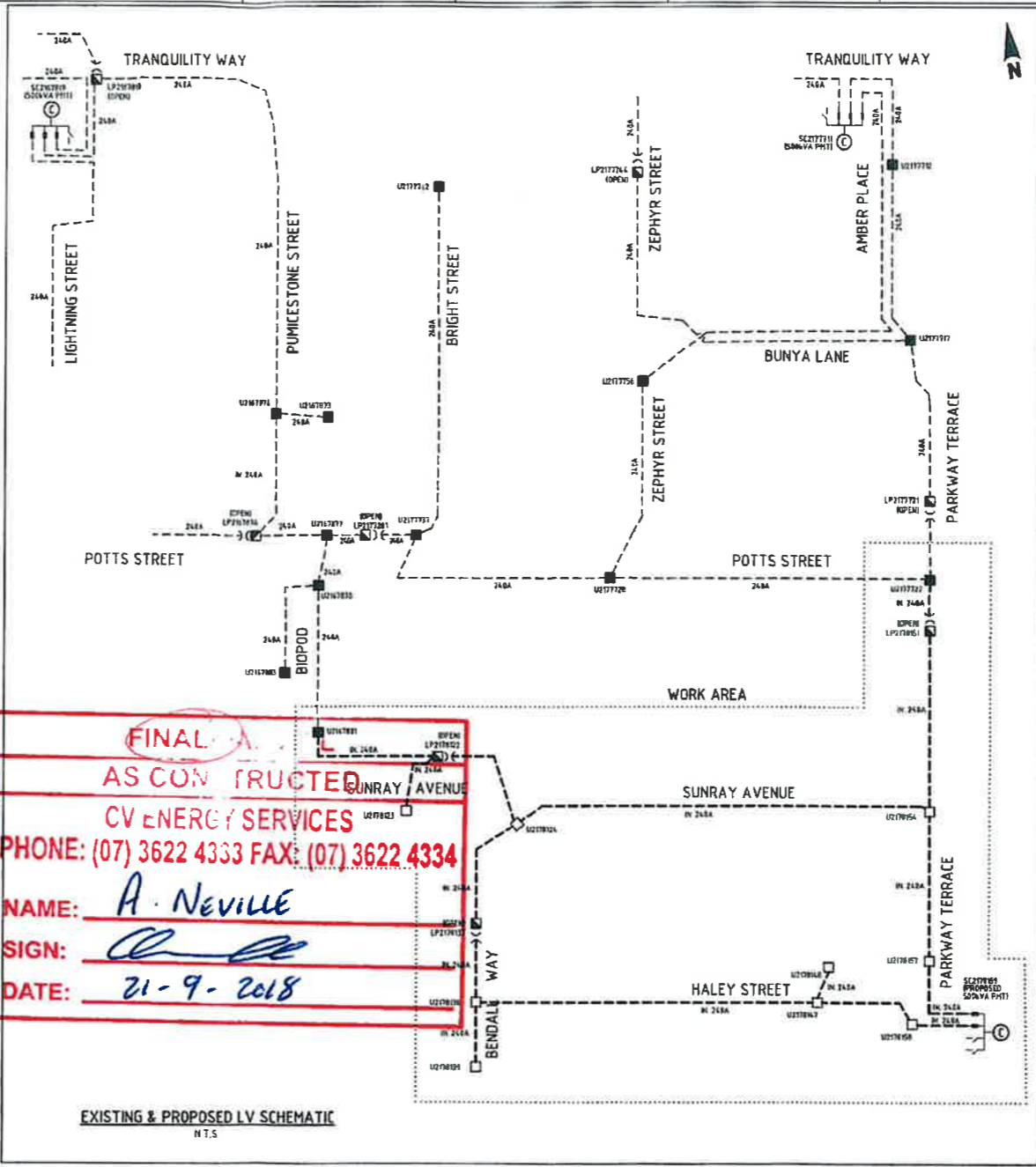
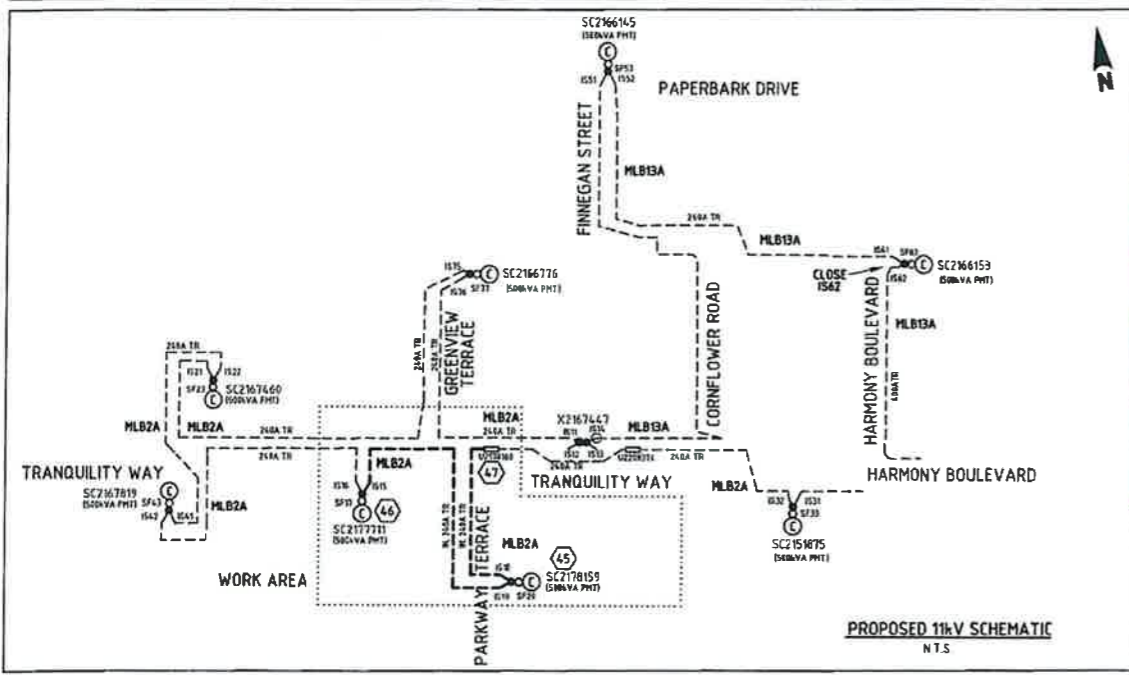
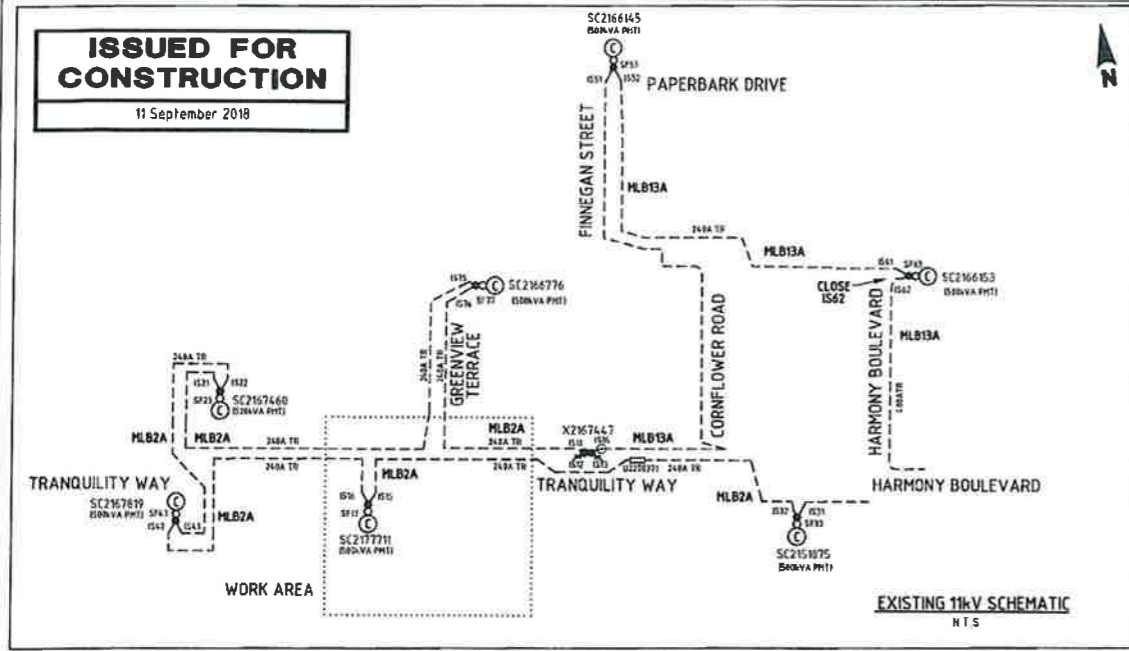

**FINAL AS CONSTRUCTED**  
**CV ENERGY SERVICES**  
PHONE: (07) 3622 4333 FAX: (07) 3622 4334  
NAME: A. NEVILLE  
SIGN: [Signature]  
DATE: 21-9-2018

CIRCUIT NO.	LABEL SIZE	LABEL COLOUR	LETTER SIZE	LABEL INFORMATION
1	150x50	WB	5	TO PARKWAY TCE LP2178159 / POTTIS ST LP2178159 / BRIGHT ST LP2178159 / TRANQUILITY WAY SC2177711 & SERVICES
2	150x50	WB	5	EXISTING

CIRCUIT NO.	LABEL SIZE	LABEL COLOUR	LETTER SIZE	LABEL INFORMATION
1	150x50	WB	5	TO TRANQUILITY WAY LP2178159 / TRANQUILITY WAY SC2177711 / POTTIS ST LP2178159 / BRIGHT ST LP2178159 & SERVICES
2	150x50	WB	5	TO BRIGHT ST LP2178159 / TRANQUILITY WAY SC2177711 / PARKWAY TCE LP2178159 & SERVICES

CIRCUIT NO.	LABEL SIZE	LABEL COLOUR	LETTER SIZE	LABEL INFORMATION
1	150x50	WB	5	TO TRANQUILITY WAY SC2177711 / POTTIS ST LP2178159 / BRIGHT ST LP2178159 & SERVICES
2	150x50	WB	5	EXISTING

CIRCUIT NO.	LABEL SIZE	LABEL COLOUR	LETTER SIZE	LABEL INFORMATION
1	150x50	WB	5	TO TRANQUILITY WAY LP2178159 / TRANQUILITY WAY SC2177711 / POTTIS ST LP2178159 / BRIGHT ST LP2178159 & SERVICES
2	150x50	WB	5	TO TRANQUILITY WAY LP2178159 / TRANQUILITY WAY SC2177711 / POTTIS ST LP2178159 / BRIGHT ST LP2178159 & SERVICES

CIRCUIT NO.	LABEL SIZE	LABEL COLOUR	LETTER SIZE	LABEL INFORMATION
1	150x50	WB	5	TO PARKWAY TCE SC2178159 & SERVICES
2	150x50	WB	5	TO BRIGHT ST LP2178159 / PARKWAY TCE LP2178159 / PARKWAY TCE SC2178159 & SERVICES

CIRCUIT NO.	LABEL SIZE	LABEL COLOUR	LETTER SIZE	LABEL INFORMATION
1	150x50	WB	5	TO POTTIS ST LP2178159 / POTTIS ST LP2178159 / TRANQUILITY WAY LP2178159 / TRANQUILITY WAY SC2177711 & SERVICES
2	150x50	WB	5	TO BENDALL WAY LP2178159 / PARKWAY TCE LP2178159 / PARKWAY TCE SC2178159 & SERVICES

CIRCUIT NO.	LABEL SIZE	LABEL COLOUR	LETTER SIZE	LABEL INFORMATION
1	150x50	WB	5	TO PARKWAY TCE SC2178159 / SUNRAY AVE LP2178159 / BENDALL WAY LP2178159 & SERVICES
2	150x50	WB	5	TO BENDALL WAY LP2178159 / PARKWAY TCE LP2178159 / PARKWAY TCE SC2178159 & SERVICES

CIRCUIT NO.	LABEL SIZE	LABEL COLOUR	LETTER SIZE	LABEL INFORMATION
1	150x50	WB	5	TO PARKWAY TCE SC2178159 / SUNRAY AVE LP2178159 / BENDALL WAY LP2178159 / BENDALL WAY LP2178159 & SERVICES
2	150x50	WB	5	TO BENDALL WAY LP2178159 / PARKWAY TCE LP2178159 / PARKWAY TCE SC2178159 & SERVICES

\* LABELS CHANGED AS PER RELEASE 7 - ENERGEX PROJECT No. S0500819

LABEL SIZE	LABEL COLOUR	LETTER SIZE	LABEL INFORMATION	LABEL LOCATION	LABEL DESCRIPTION
150x40	WB	20	SC2151875	FRONT	RMU IDENTIFICATION
50x20	BLUE W	10		FRONT	DESIGN IDENTIFICATION
100x30	GW	8		NEAR EARTH SW	EARTH SWITCH DESCRIPTION
100x40	WB	15	IS31	NEAR ISOLATOR	ISOLATOR IDENTIFICATION
150x40	BW	20		FRONT	FEEDER IDENTIFICATION
150x50	BW	10	EXISTING	TO PARKWAY TCE SC2178159 IS18	EXISTING CABLE BOX CABLE DESTINATION
150x50	BW	10	EXISTING	TO PARKWAY TCE SC2178159 IS18	EXISTING INSIDE SIDE WALL CABLE DESTINATION

LABEL SIZE	LABEL COLOUR	LETTER SIZE	LABEL INFORMATION	LABEL LOCATION	LABEL DESCRIPTION
150x40	WB	20	SC2177711	FRONT	RMU IDENTIFICATION
50x20	BLUE W	10		FRONT	DESIGN IDENTIFICATION
100x30	GW	8		NEAR EARTH SW	EARTH SWITCH DESCRIPTION
100x40	WB	15	IS15	NEAR ISOLATOR	ISOLATOR IDENTIFICATION
150x40	BW	20		FRONT	FEEDER IDENTIFICATION
150x50	BW	10	TO PARKWAY TCE SC2178159 IS19	EXISTING	EXISTING CABLE BOX CABLE DESTINATION
150x50	BW	10	TO PARKWAY TCE SC2178159 IS19	EXISTING	EXISTING INSIDE SIDE WALL CABLE DESTINATION

LABEL SIZE	LABEL COLOUR	LETTER SIZE	LABEL INFORMATION	LABEL LOCATION	LABEL DESCRIPTION
150x40	WB	20	SC2178159	FRONT	RMU IDENTIFICATION
50x20	BLUE W	10		FRONT	DESIGN IDENTIFICATION
100x30	GW	8		NEAR EARTH SW	EARTH SWITCH DESCRIPTION
100x40	WB	15	IS18	NEAR ISOLATOR	ISOLATOR IDENTIFICATION
150x40	BW	20		FRONT	FEEDER IDENTIFICATION
150x50	BW	10	TO HERFORD ST SC2151875 IS32	TO TRANQUILITY WAY SC2177711 IS15	TO TRANSFORMER
150x50	BW	10	TO HERFORD ST SC2151875 IS32	TO TRANQUILITY WAY SC2177711 IS15	TO TRANSFORMER

FOR LABEL DETAILS SEE BELOW

SC2177711 FUSE LAYOUT

FOR LABEL DETAILS SEE BELOW

SC2167819 FUSE LAYOUT

FOR LABEL DETAILS SEE BELOW

SC2178159 FUSE LAYOUT

CIRCUIT NO.	LABEL SIZE	LABEL COLOUR	LETTER SIZE	LABEL INFORMATION
1	80x35	WB	5	TRANSFORMER ISOLATOR
2	80x35	WB	5	EXISTING
3	80x35	WB	5	EXISTING
4	80x35	WB	5	EXISTING

CIRCUIT NO.	LABEL SIZE	LABEL COLOUR	LETTER SIZE	LABEL INFORMATION
1	80x35	WB	5	TRANSFORMER ISOLATOR
2	80x35	WB	5	TO TRANQUILITY WAY LP2178159 / POTTIS ST LP2178159 / SUNRAY AVE LP2178159 / BENDALL WAY LP2178159 & SERVICES
3	80x35	WB	5	EXISTING
4	80x35	WB	5	SPARE

CIRCUIT NO.	LABEL SIZE	LABEL COLOUR	LETTER SIZE	LABEL INFORMATION
1	80x35	WB	5	TRANSFORMER ISOLATOR
2	80x35	WB	5	TO PARKWAY TCE LP2178159 / SUNRAY AVE LP2178159 / BENDALL WAY LP2178159 / BENDALL WAY LP2178159 & SERVICES
3	80x35	WB	5	EXISTING
4	80x35	WB	5	SPARE

- POP** PRIVATELY OPERATED PAYPHONES
- APS** ASSISTANCE TELEPHONES (EG ELEVATOR AND ROADSIDE PHONES)
- MET** APPLY TO OTHER TYPE OF METERING POINT ( any service)
- ATM** ATM
- PRK** BANDSTAND / ROTUNDA / SPORTS FIELD STANDS / OTHER PARK BUILDING
- PSD** POINT OF SALE DEVICE (vending machine, ticket machine)
- TRF** Traffic Lights / Traffic Light Controller / Variable Speed Sign / Traffic Signal
- PBT** Public Transport (bus stop, tram stop, railway station, taxi rank, ferry wharf)
- SWT** Links / Link Pole / MV / HV Links / ABC Links / Dynamic Switch / Airbrake Switch / Isolator
- WAT** Water Infrastructure (storage, pumps, valves water supply, waste water, sewerage stations)
- GAS** Natural Gas Infrastructure
- CAM** Camera (security / traffic)
- CTL** Bridge control, swing bridge, traffic control gates, railway boom gates)
- MOB** Mobile Phone Tower / radio antenna
- LIT** Street Lighting Pole / street light controller
- CAR** Unmanned (council) car park
- PWR** Transformer / Kiosk / Pad Mount Sub-station / Pole Mount Transformer

- NAP-ID** Network Access Point (NAP)
- MPT-ID** Multipoint (MPT)  
n is the number of ports (eg 4,6,8,12)

- TJL-ID** Splice Joint on a Transit Cable (TJL)
- DJL-ID** Splice Joint on a Distribution Cable (DJL)
- LL-0** Splice Joint on a Local Cable (LJL)
- MJL-ID** Splice Joint on a Tether Cable (MJL)
- AJL-ID** Zone Terminal / Splice Joint (AJL)
- FDH-ID** Fibre Distribution Hub-FDH Cabinet with Cabinet ID shown
- PIT-ID 2** Service Drop Access Pit (650mmX280mmX565mm)
- PIT-ID 5** Network Boundary/Local Network Pit (Single Lid) (700mmX450mmX650mm)
- PIT-ID 6** Distribution/Local Network Connection Pit (Dual Lid) (1360mmX555mmX650mm)
- PIT-ID 8** Distribution/Local Network Connection Pit (1360mmX555mmX860mm)
- PIT-ID 9** Fibre Distribution Hub (FDH) Pit (2000mmX555mmX900mm)
- Existing Telstra manhole
- Existing Telstra Pit ( 2,3,4,5,6,7,8,9 )
- Telstra exchange
- Example of Telstra Major Conduit Layout with Proposed duct marked to be used by NBN
- M** < -> NBN MARKER POST  
MARKER POST TO BE NUMBERED
- DES QTY** Example of descriptor box that will show the type of work and the quantity involved
- PCD** Premise Connection Device (PCD)
- POLE-ID** Pole (showing pole identity)
- FAN AAAA** Fan Access Node site (FAN)
- 138A** <sup>RX</sup> <sub>CX</sub> Multi Dwelling Unit (MDU)

**DEPTH--**  
**ALIGN--** DEPTH OVER ALIGNMENT SYMBOL TO BE USED WITH EVERY MARKER POST

Symbol to be used when replacing/removing existing network

CABLE TRAY:

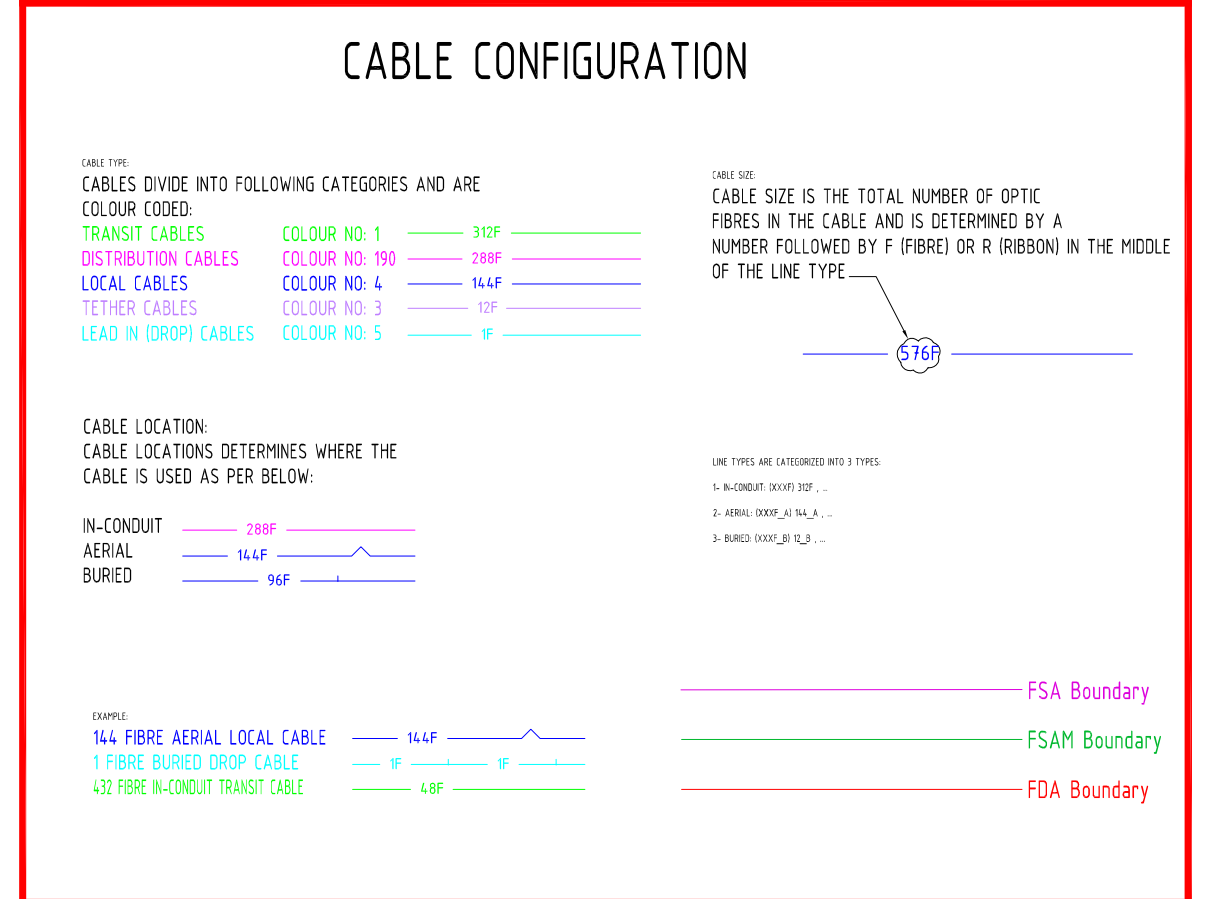
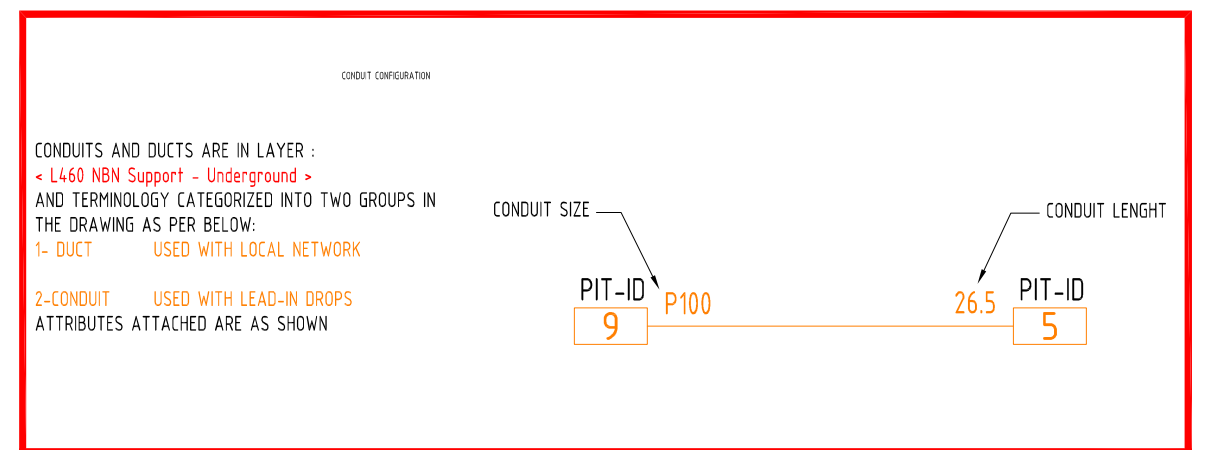

**STAFF WORKING ON THIS ESTIMATE PLEASE NOTE:**  
The location of other authorities services which may affect this work have not been obtained by the estimator. Constructor to obtain service information before commencing.

**DANGER LASER BEAM**  
EYE PROTECTION MUST BE WORN

**SAFETY FIRST**  
SAFETY STARTS WITH YOU



REV	DATE	DRAFTER	DESCRIPTION	APPROVED
D	13/08/2018	ENYA AMOS	AS BUILT	TONY FOSTER
C	12/06/2018	ENYA AMOS	ISSUED FOR CONSTRUCTION	TONY FOSTER
B	16/05/2018	LACHLAN BRAUNLEIN	GEOREFERENCING AND CADASTRE LAYER ITEMS AMENDED	TONY FOSTER
A	17/04/2018	DANIEL CAMERON	PIT-021 SIZE, DUCT PIT-005 TO PIT-006, CO-ORDINATES	TONY FOSTER
PR1	23/02/2018	ENYA AMOS	PRELIMINARY DESIGN	TONY FOSTER

**STRICTLY CONFIDENTIAL**

NBNCO APPROVAL RECORD:

	SIGNATURE	DATE
<input type="checkbox"/>	DD	
<input type="checkbox"/>	WD	
<input type="checkbox"/>	AB	

QUALITY RECORD:

NBNCO DISCLAIMER  
THIS DOCUMENT HAS BEEN PREPARED SOLELY FOR THE USE OF NBNCO LIMITED (ABN 86 136 533 741) FOR USE IN MAINTAINING NBNCO FACILITIES. IT HAS NOT BEEN CREATED FOR ANY OTHER USE. IT SHOULD NOT BE SCALED TO LOCATE NBNCO ASSETS. NO WARRANTY IS GIVEN THAT THE INFORMATION IS ACCURATE OR COMPLETE.

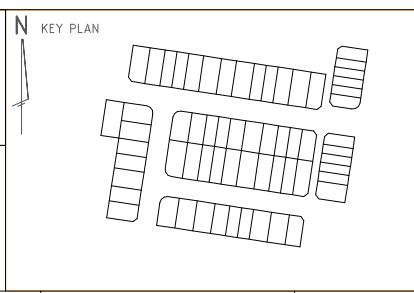

DRAWING TITLE:  
NBN PIT & PIPE DESIGN  
PALMVIEW HARMONY ESTATE - RELEASE 5  
PETER CROSBY WAY  
SIPPY DOWNS

STATE: QLD REGION:

FSA: SAM: ADA:

PROJECT No: AYCA-55AZK7

CADREF No:

SCALE: 1:500 SHEET No: 1 OF 2 REV: 0



AS CONSTRUCTED

Development Information				
Development Name: PALMVIEW ESTATE				
Developer Company: AVID RESIDENTIAL GROUP PTY LTD				
Development Address: PALMVIEW ESTATE				
Authorised Rep: TONY FOSTER				
Phone: 0448903388				
E-Mail: TONY.FOSTER@CVSERVICES.COM.AU				
CRM ID: AYCA-55AZK7	Stage Number: RELEASE 5			
BILL OF MATERIAL				
NO OF LOTS: 63				
PITS		DUCTS		
SIZE	QTY	SIZE	QTY	MTRS
2	8	P100	20	561.3
5	14	P50	10	24.0
6	0	P23	66	789.2
8	5			
9	0			
TOTAL NUMBER OF PITS: 27				
TOTAL NUMBER OF MANHOLES: 0				
TOTAL NUMBER OF CONDUITS: 96				
TOTAL LENGTH OF CONDUITS: 1590.5				

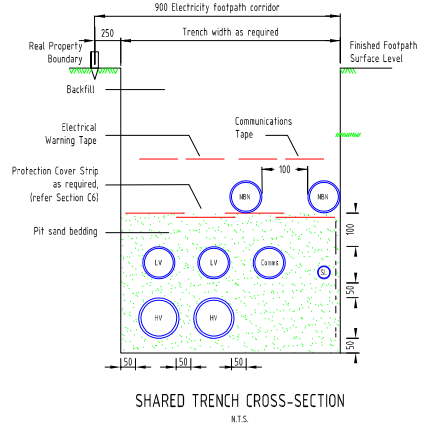

REV	DATE	DRAFTER	DESCRIPTION	APPROVED
D	13/08/2018	ENYA AMOS	AS BUILT	TONY FOSTER
C	12/06/2018	ENYA AMOS	ISSUED FOR CONSTRUCTION	TONY FOSTER
B	16/05/2018	LACHLAN BRAUNLEIN	GEOREFERENCING AND CADASTRE LAYER ITEMS AMENDED	TONY FOSTER
A	17/04/2018	DANIEL CAMERON	PIT-021 SIZE, DUCT PIT-005 TO PIT-006, CO-ORDINATES	TONY FOSTER
PR1	23/02/2018	ENYA AMOS	PRELIMINARY DESIGN	TONY FOSTER

STRICTLY CONFIDENTIAL

NBNCO APPROVAL RECORD:

	SIGNATURE	DATE
<input type="checkbox"/>	DD	
<input type="checkbox"/>	WD	
<input type="checkbox"/>	AB	

QUALITY RECORD:

NBNCO DISCLAIMER  
THIS DOCUMENT HAS BEEN PREPARED SOLELY FOR THE USE OF NBNCO LIMITED (ABN 86 136 533 741) FOR USE IN MAINTAINING NBNCO FACILITIES. IT HAS NOT BEEN CREATED FOR ANY OTHER USE. IT SHOULD NOT BE SCALED TO LOCATE NBNCO ASSETS. NO WARRANTY IS GIVEN THAT THE INFORMATION IS ACCURATE OR COMPLETE.

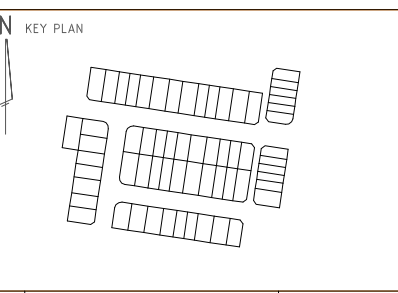

DRAWING TITLE:  
NBN PIT & PIPE DESIGN  
PALMVIEW HARMONY ESTATE - RELEASE 5  
PETER CROSBY WAY  
SIPPY DOWNS

STATE: QLD	REGION:	
FSA:	SAM:	ADA:
PROJECT No: AYCA-55AZK7		
CADREF No:		
SCALE: 1:500	SHEET No: 2	OF 2
REV: D		